



***Punch
and Die
Centre***

PUNCH AND DIE CATALOGUE 2016



PROFESSIONAL TOOLS

annular cutters – rail cutters – twist drills – spade drills – hole saws – countersinks
step drills - magnetic Base Drills - punches & dies - carbide burrs

www.punchanddiecentre.com.au



QUALITY CUTTING TOOLS PTY LTD

ABN 50 089 561 339

PO Box 488 North Lakes Qld 4509

Unit 13, 8 Oxley Street North Lakes Qld 4509

Ph: 07 3205 2799

Fax: 07 3205 5730

www.qctools.com.au

PUNCHES & DIES



QUALITY TOOLING

- Punches
- Dies
- Bar Stock Blades
- Notching Blades
- Shear Blades
- Punch Holders & Nuts
- Punch & Die Reducers

TOOLING FOR STEELWORKERS - CONTENTS

| | | |
|--------------------|-------|-------|
| SHAPES | _____ | 3 |
| FICEP | _____ | 4 |
| GEKA | _____ | 5 - 6 |
| KINGSLAND | _____ | 7 |
| MARKSMAN | _____ | 8 |
| MUBEA | _____ | 9 |
| NITTO-KHOKI | _____ | 10 |
| OMERA | _____ | 10 |
| PEDDINGHAUS | _____ | 11 |
| SCOTCHMAN | _____ | 12 |
| SUNRISE | _____ | 12-13 |
| ORDER CONFIRMATION | _____ | 14 |
| NOTES ON USE | _____ | 15 |

DIRECTORY

| | | |
|----------------------------|--------------------------------|-------|
| DURMA | - SEE GEKA PAGE | 5 |
| FABTECH | - SEE MUBEA PAGE | 9 |
| FICEP | - SEE FICEP PAGE | 4 |
| GEKA | - SEE GEKA PAGE | 5-6 |
| IMS | - SEE PEDDINGHAUS PAGE | 11 |
| KINGSLAND | - SEE KINGSLAND PAGE | 7 |
| KIPPEN | - SEE PEDDINGHAUS PAGE | 11 |
| MADISON | - SEE MUBEA PAGE | 9 |
| MARKSMAN | - SEE MARKSMAN PAGE | 8 |
| METALMASTER | - SEE MUBEA PAGE | 9 |
| MUBEA | - SEE MUBEA PAGE | 9 |
| NITTO KOHKI/SELFER | - SEE NITTO KOHKI PAGE | 10 |
| OMERA | - SEE OMERA PAGE | 10 |
| PACIFIC | - SEE KINGSLAND PAGE | 7 |
| PEDDINGHAUS | - SEE PEDDINGHAUS PAGE | 11 |
| PUNCHTECH | - SEE MUBEA PAGE | 9 |
| SCOTCHMAN | - SEE SCOTCHMAN PAGE | 12 |
| SELFER | - SEE NITTO-KHOKI PAGE | 10 |
| STEELMASTER | - SEE KINGSLAND PAGE | 7 |
| SUNRISE (PRE 2000) | - SEE SUNRISE (PRE 2000) PAGE | 13 |
| SUNRISE (POST 2000) | - SEE SUNRISE (POST 2000) PAGE | 12-13 |

PLEASE CONTACT SALES FOR INFORMATION ON THE FOLLOWING - sales@punchanddiecentre.com.au

EDWARDS • GAIRU • OMES • ROYAL • SHARP • UNI-HYDRO • OR OTHER...

STANDARD SHAPES

ROUND



OBLONG



SQUARE

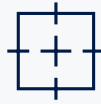

RECTANGLE



HEX



FLATTED ROUND



DBL FLATTED ROUND



FLATTED OBLONG



SQUARE RADIUS CNR



KEYHOLE STYLE - A



KEYHOLE STYLE - B



KEYHOLE STYLE - D



TRIANGLE



Many other shapes are available and we are happy to quote on your specialised requirements.

Dies are available in .2mm, .7mm, 1.2mm and 1.7mm clearances

SPECIAL SHAPES



Radiusing

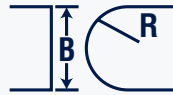

Shearing
& Radiusing

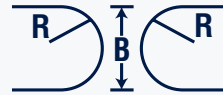

Shearing
& double-sided
Radiusing



Corner Radiusing

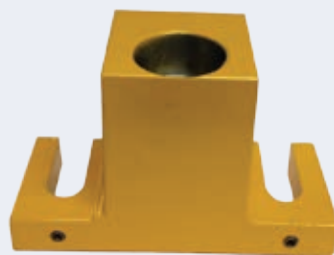

FICEP - STOCK ITEMS

210/16

ROUND \$36.00 21016RP

SHAPE \$92.00 21016OP

210/16

ROUND \$40.00 21016RD

SHAPE \$100.00 21016OD

| | |
|--------|--|
| ROUND | 4mm - 31mm in 1mm increments |
| OBLONG | 6x20, 8x20, 8x25, 10x20, 10x25, 10x30, 12x20, 12x25, 12x30 14x25, 14x30, 16x25, 16x30, 18x25, 18x30, 20x30, 22x30, 24x30 |

Other sizes are available on a made to order basis.

FICEP - NON STOCK ITEMS

FICEP 10

FICEP 13

FICEP 14

FICEP 16

FICEP H4

FICEP 10

FICEP 13

FICEP 14

FICEP 16

FICEP H4

These punches and dies are a made to order basis

NO.6 STOCK

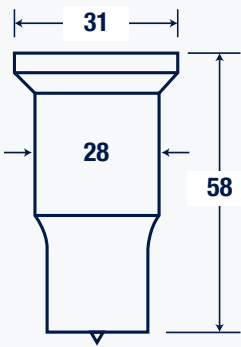

ROUND \$36.00 GEKA13RP

SHAPE \$92.00 GEKA130P

NO.6 STOCK

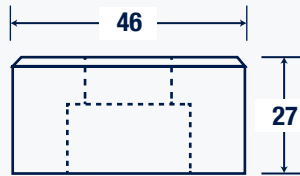

ROUND \$40.00 21013RD

SHAPE \$100.00 210130D

ROUND 5mm - 28mm in 1mm increments

OBLONG 8x20, 8x25, 10x20, 10x25, 10x28, 12x20, 12x25, 14x25, 14x28, 18x25, 18x28, 22x28

NO.8/31 STOCK

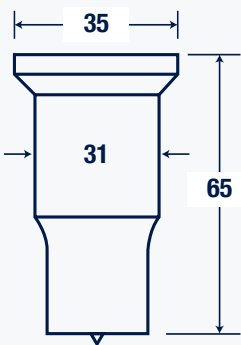

ROUND \$36.00 21016RP

SHAPE \$92.00 210160P

NO.3 STOCK

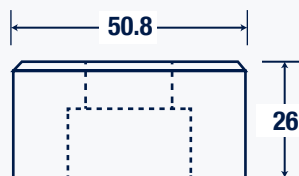

ROUND \$40.00 21016RP

SHAPE \$100.00 210160P

ROUND 4mm - 31mm in 1mm increments

OBLONG 6x20, 8x20, 8x25, 10x20, 10x25, 10x30, 12x20, 12x25, 12x30, 14x25, 14x30, 16x25, 16x30, 18x25, 18x30, 20x30, 22x30, 24x30

NO.8 STOCK

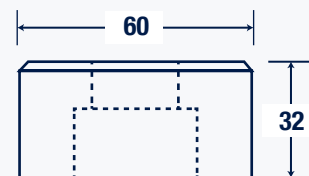

ROUND \$40.00 N08RD

SHAPE \$100.00 N080D

NO.8/40 STOCK

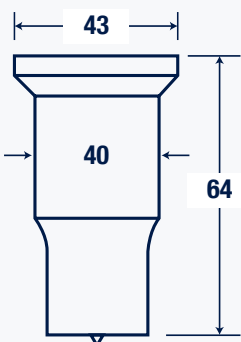

ROUND \$50.00 GEKA840RP

SHAPE \$116.00 GEKA8400P

NO.8 STOCK

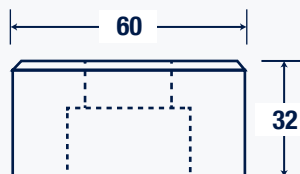

ROUND \$40.00 N08RD

SHAPE \$100.00 N080D

ROUND 40mm

OBLONG 14x40, 18x40, 20x40, 22x40, 24x40

Other sizes are available on a made to order basis.

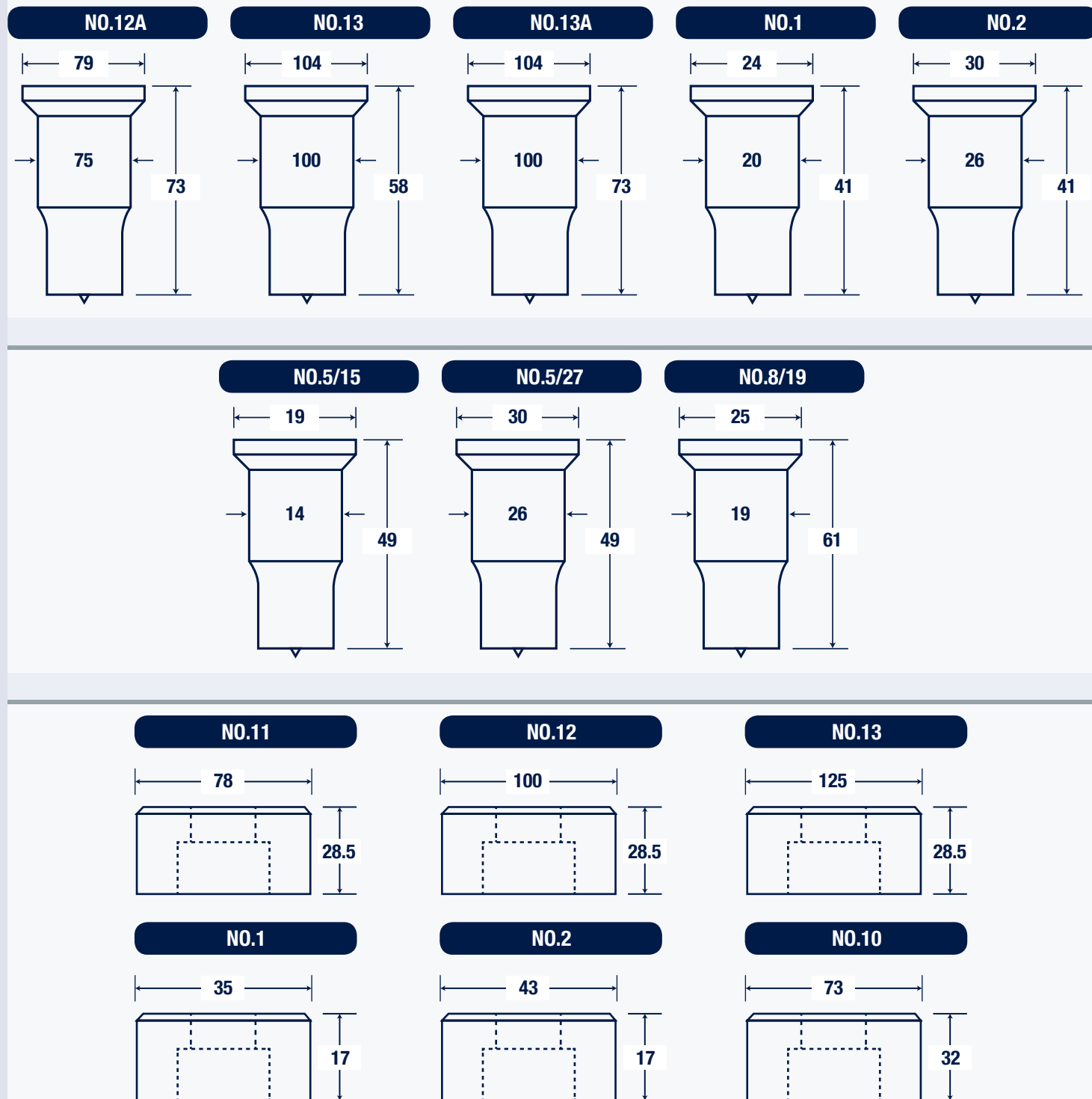

Other sizes are available on a made to order basis.

9001 STOCK

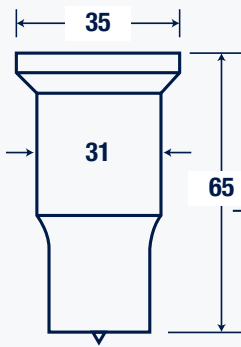

ROUND \$36.00 21016RP

SHAPE \$92.00 21016OP

ROUND

4mm - 31mm in 1mm increments

OBLONG

6x20, 8x20, 8x25, 10x20, 10x25x 10x30, 12x20, 12x25, 12x30, 14x25, 14x30, 16x25, 16x30, 18x25, 18x30, 20x30, 22x30, 24x30

Other sizes are available on a made to order basis.

ROUND

5mm - 38mm in 1mm increments

OBLONG

10x25, 12x25, 12x30, 14x25, 14x30, 18x25, 18x30, 18x38

9004 STOCK

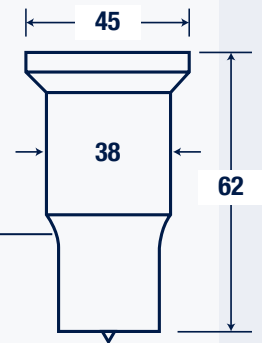

ROUND \$44.00 K9004RP

SHAPE \$100.00 K9004OP

9006 STOCK

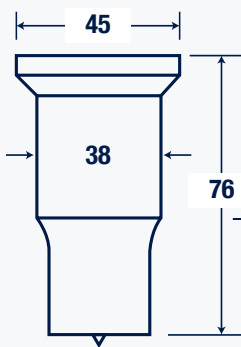

ROUND \$65.00 K9006RP

SHAPE \$130.00 K9006OP

ROUND

6mm - 38mm in 2mm increments

OBLONG

14x30, 18x30, 18x38, 22x30, 22x38

ROUND

6mm - 38mm in 2mm increments

OBLONG

14x30, 18x30, 18x38, 22x30, 22x38

9023 NO.8 STOCK

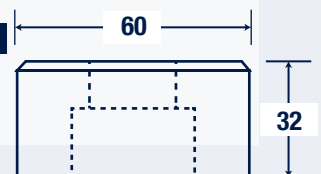

ROUND \$40.00 NO8RD

SHAPE \$100.00 NO8OD

KINGSLAND - NON STOCK ITEMS

9000

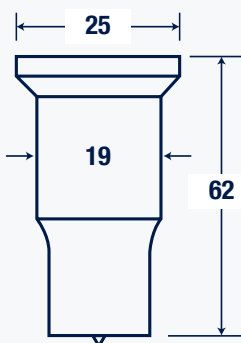

9007

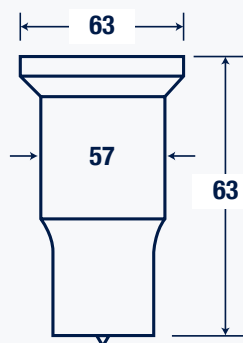

9009

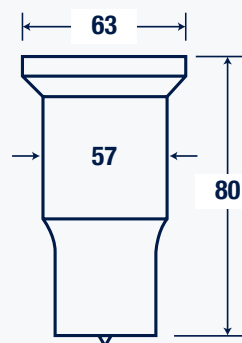

9024

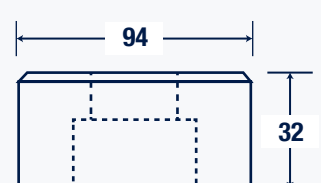

These punches and dies are a made to order basis.

GR2 STOCK

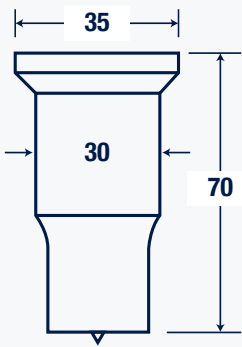

| | | |
|-------|---------|-------|
| ROUND | \$36.00 | GR2RP |
| SHAPE | \$92.00 | GR20P |

| | |
|--------|-----------------------------------|
| ROUND | 4mm - 30mm in 1mm increments |
| OBLONG | 14x40, 16x40, 18x40, 22x40, 26x40 |

NO.8 STOCK

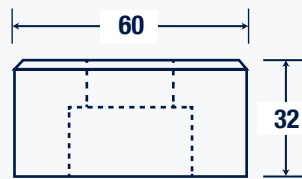

| | | |
|-------|----------|-------|
| ROUND | \$40.00 | N08RD |
| SHAPE | \$100.00 | N080D |

GR3 STOCK

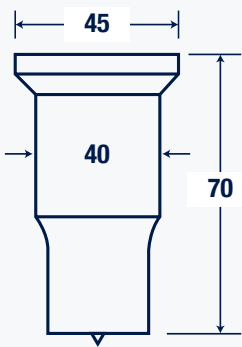

| | | |
|-------|----------|-------|
| ROUND | \$40.00 | GR3RP |
| SHAPE | \$100.00 | GR30P |

| | |
|--------|-----------------------------------|
| ROUND | 32mm - 40mm in 1mm increments |
| OBLONG | 14x40, 16x40, 18x40, 22x40, 26x40 |

NO.8 STOCK

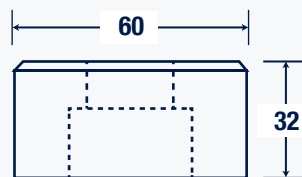

| | | |
|-------|----------|-------|
| ROUND | \$40.00 | N08RD |
| SHAPE | \$100.00 | N080D |

GR4 STOCK

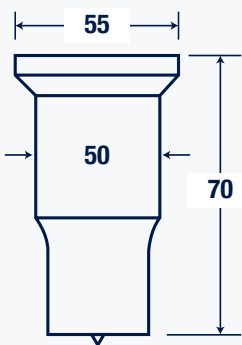

| | | |
|-------|----------|-------|
| ROUND | \$112.00 | GR4RP |
| SHAPE | \$176.00 | GR40P |

| | |
|--------|--------------|
| ROUND | 50mm |
| OBLONG | 18x50, 22x50 |

GR4 STOCK

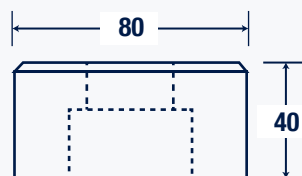

| | | |
|-------|----------|-------|
| ROUND | \$112.00 | GR4RD |
| SHAPE | \$198.00 | GR40D |

Other sizes are available on a made to order basis.

GR1 STOCK

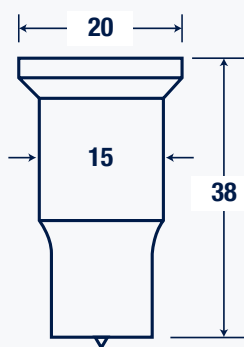

ROUND \$36.00 GR1RD

SHAPE \$92.00 GR10D

GR1 STOCK

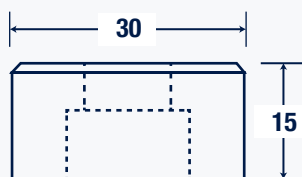

ROUND \$40.00 GR1RD

SHAPE \$100.00 GR10D

ROUND 4mm - 15mm in 1mm increments

GR2 STOCK

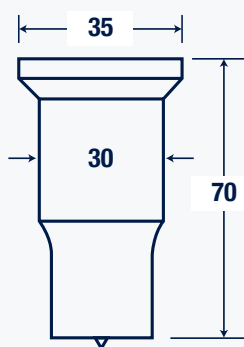

ROUND \$36.00 GR2RD

SHAPE \$92.00 GR20D

GR2 STOCK

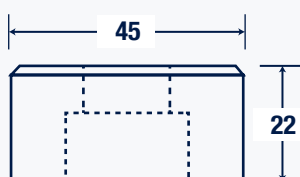

ROUND \$40.00 GR2RD

SHAPE \$100.00 GR20D

ROUND 4mm - 30mm in 1mm increments

OBLONG 8x20, 8x25, 10x20, 10x25x 10x30, 12x20, 12x25, 12x30, 14x20, 14x25, 14x30, 16x30, 18x25, 18x30, 22x30, 24x30

GR3 STOCK

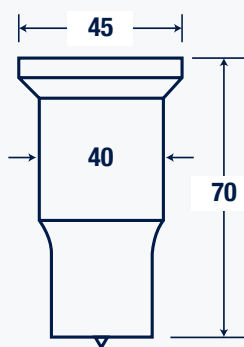

ROUND \$40.00 GR3RD

SHAPE \$100.00 GR30D

NO.8 STOCK

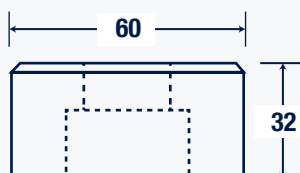

ROUND \$40.00 N08RD

SHAPE \$100.00 N080D

ROUND 32mm - 40mm in 1mm increments

OBLONG 14x40, 16x40, 18x40, 22x40, 26x40

GR4 STOCK

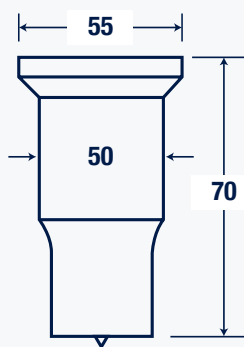

ROUND \$112.00 GR4RD

SHAPE \$176.00 GR40D

GR4 STOCK

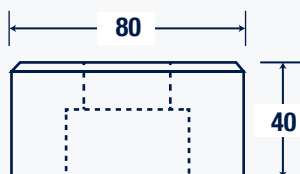

ROUND \$112.00 GR4RD

SHAPE \$198.00 GR40D

ROUND 50MM

OBLONG 18x50, 22x50

Other sizes are available on a made to order basis.

NITTO SELFER STOCK

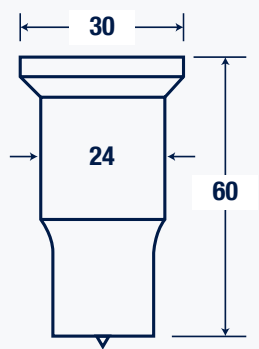

| | | |
|-------|---------|---------|
| ROUND | \$36.00 | NITTORP |
| SHAPE | \$92.00 | NITTOOP |

NITTO SELFER STOCK

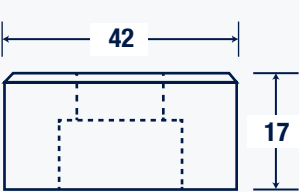

| | | |
|-------|----------|---------|
| ROUND | \$40.00 | NITTORD |
| SHAPE | \$100.00 | NITTOOD |

Offset - Round
only
\$55.00

ROUND 6mm - 26mm in 1mm increments

Other sizes are available on a made to order basis.

OMERA

OM13 STOCK

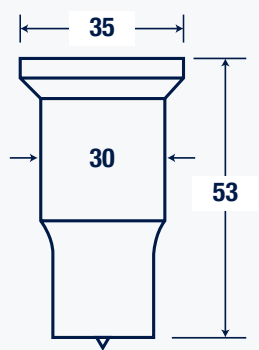

| | | |
|-------|---------|--------|
| ROUND | \$36.00 | OM13RP |
| SHAPE | \$92.00 | OM13OP |

OM13 STOCK

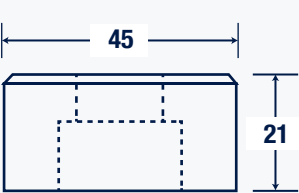

| | | |
|-------|----------|--------|
| ROUND | \$40.00 | OM13RD |
| SHAPE | \$100.00 | OM13OD |

ROUND OM13 5mm - 30mm in 1mm increments

OM16 STOCK

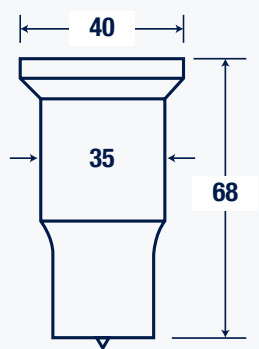

| | | |
|-------|----------|--------|
| ROUND | \$55.00 | OM16RP |
| SHAPE | \$110.00 | OM16OP |

OM16 STOCK

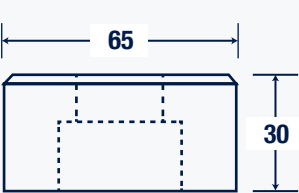

| | | |
|-------|----------|--------|
| ROUND | \$55.00 | OM16RD |
| SHAPE | \$110.00 | OM16OD |



ROUND 5mm - 35mm in 1mm increments

Other sizes are available on a made to order basis.

These punches and dies are a made to order basis

NO.4 210/13 STOCK

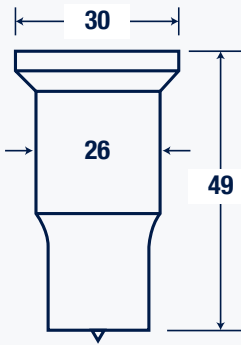

ROUND \$36.00 21013RP

SHAPE \$92.00 21013OP

NO.2 210/13 STOCK

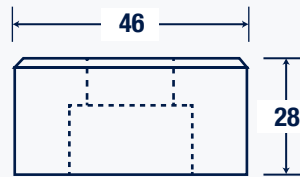

ROUND \$40.00 21013RD

SHAPE \$100.00 21013OD

ROUND 5mm - 26mm in 1mm increments

OBLONG 10x20, 10x25, 12x25, 14x25, 16x25, 18x25

NO.5 210/16 STOCK

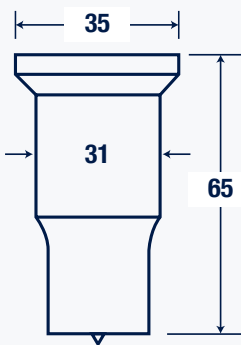

ROUND \$36.00 21016RP

SHAPE \$92.00 21016OP

NO.3 210/16 STOCK

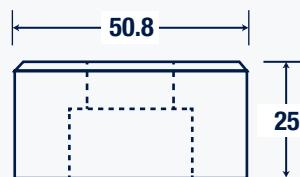

ROUND \$40.00 21016RD

SHAPE \$100.00 21016OD

ROUND 4mm - 31mm in 1mm increments

OBLONG 6x20, 8x20, 8x25, 10x20, 10x25x 10x30, 12x20, 12x25, 12x30, 14x25, 14x30, 16x25, 16x30, 18x25, 18x30, 20x30, 22x30, 24x30

Other sizes are available on a made to order basis.

PEDDINGHAUS - NON STOCK ITEMS

NO.1

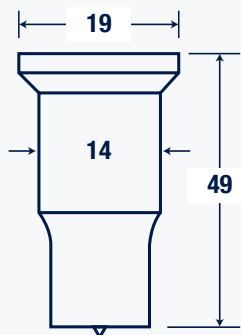

NO.2

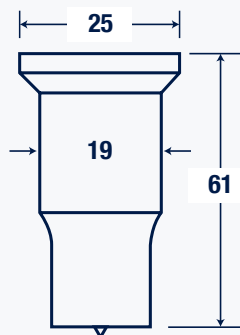

NO.3

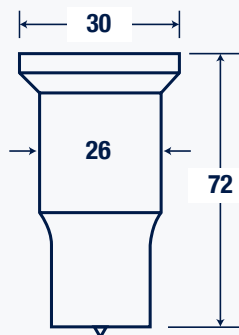

NO.6

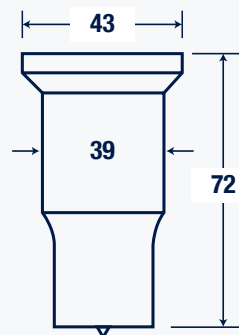

NO.7

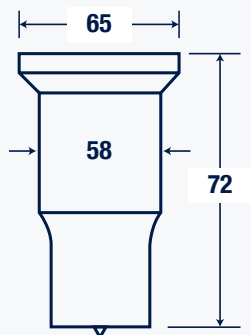

NO.11

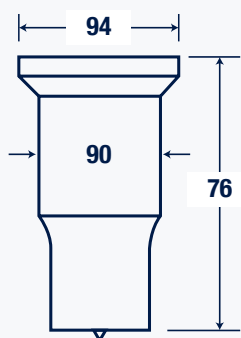

NO.1

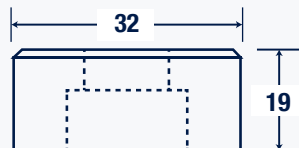

NO.4

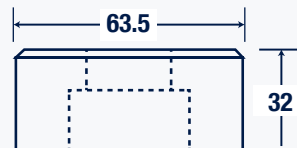

NO.5

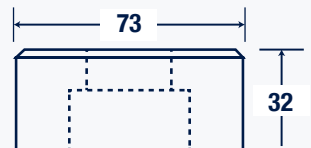

NO.6

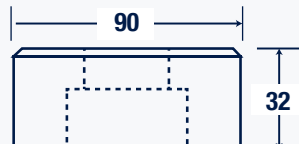

NO.20

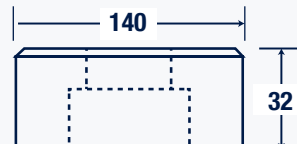

Other sizes are available on a made to order basis.

SCOTCHMAN - STOCK ITEMS

210/16 STOCK

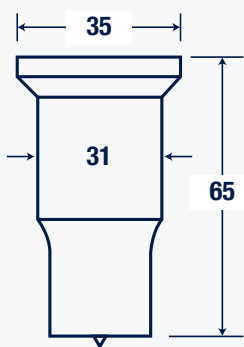

ROUND \$36.00 21016RP

SHAPE \$92.00 21016OP

ROUND 4mm - 31mm in 1mm increments

OBLONG 6x20, 8x20, 8x25, 10x20, 10x25x 10x30, 12x20, 12x25, 12x30, 14x25, 14x30, 16x25, 16x30, 18x25, 18x30, 20x30, 22x30, 24x30

210/16 STOCK

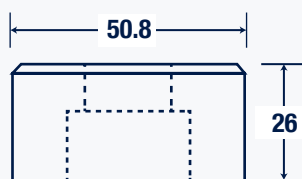

ROUND \$40.00 21016RD

SHAPE \$100.00 21016OD

S314

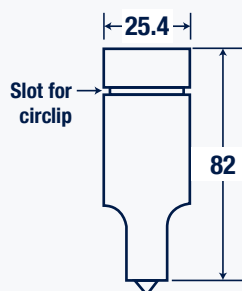

S314

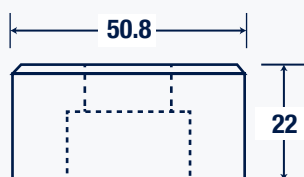

S314 Punch and Die Available only on a made to order basis

Other sizes are available on a made to order basis.

SUNRISE - GEKA STYLE (POST 2000)

NO.5 210/16 STOCK

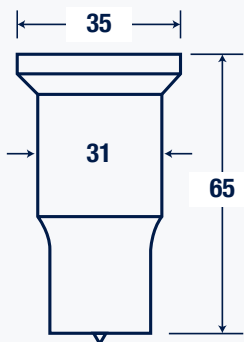

ROUND \$36.00 21016RP

SHAPE \$92.00 21016OP

ROUND Punch = 4-31mm in 1mm Increments – 210/13 Die = 4-27mm (larger sizes see No.8 Die)

OBLONG 6x20, 8x20, 8x25, 10x20, 10x25x 10x30, 12x20, 12x25, 12x30, 14x25, 14x30, 16x25, 16x30, 18x25, 18x30, 20x30, 22x30, 24x30

NO.2 210/13 STOCK

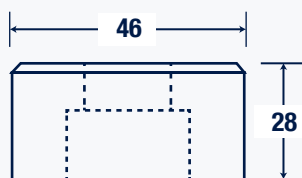

ROUND \$40.00 21013RD

SHAPE \$100.00 21013OD

GR3

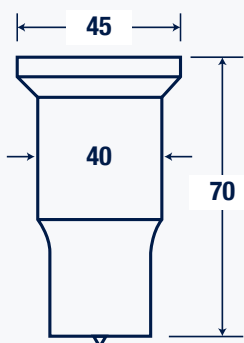

ROUND \$40.00 GR3RP

SHAPE \$100.00 GR3OP

ROUND 32mm - 40mm in 1mm increments

OBLONG 14x40, 16x40, 18x40, 22x40, 26x40

NO.8 STOCK

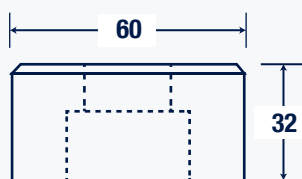

ROUND \$40.00 N08RD

SHAPE \$100.00 N08OD

GR4 STOCK

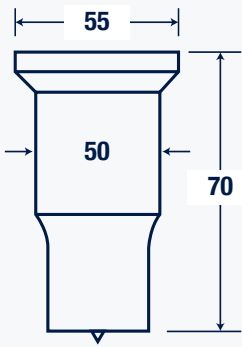

ROUND **\$112.00** GR4RP

SHAPE **\$176.00** GR40P

ROUND 50mm
OBLONG 18x50, 22x50

GR4 STOCK

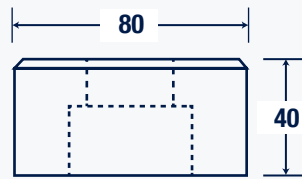

ROUND **\$112.00** GR4RD

SHAPE **\$198.00** GR40D

SUNRISE - MUBEA STYLE (PRE 2000)

GR2 STOCK

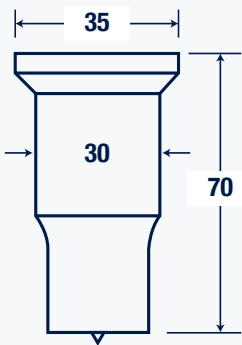

ROUND **\$36.00** GR2RP

SHAPE **\$92.00** GR20P

ROUND 4mm - 30mm in 1mm increments
OBLONG 8x20, 8x25, 10x20, 10x25x 10x30, 12x20, 12x25, 12x30, 14x20, 14x25, 14x30, 16x30, 18x25, 18x30, 22x30, 24x30

GR2 STOCK

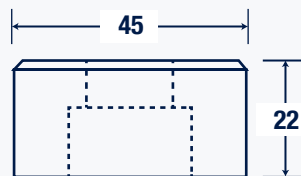

ROUND **\$40.00** GR2RD

SHAPE **\$100.00** GR20D

GR3

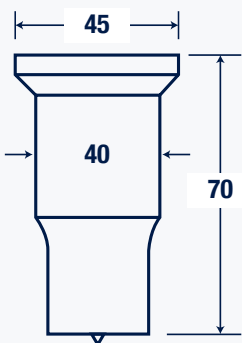

ROUND **\$40.00** GR3RP

SHAPE **\$100.00** GR30P

ROUND 32mm - 40mm in 1mm increments
OBLONG 14x40, 16x40, 18x40, 22x40, 26x40

NO.8 STOCK

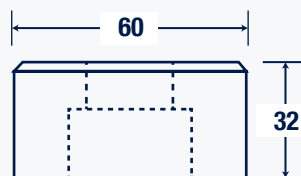

ROUND **\$40.00** N08RD

SHAPE **\$100.00** N080D

GR4

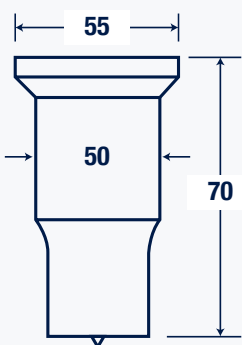

ROUND **\$112.00** GR4RP

SHAPE **\$176.00** GR40P

ROUND 50mm
OBLONG 18x50, 22x50

GR4 STOCK

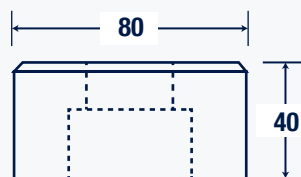

ROUND **\$112.00** GR4RD

SHAPE **\$198.00** GR40D

ORDER CONFIRMATION

COMPANY NAME:

ADDRESS:

TELEPHONE:

FAX:

CONTACT PERSON:

MACHINE TYPE AND MODEL:

SIZE OF PUNCH AND DIE REQUIRED:

SIGNED:

SHOULD YOU REQUIRE A SHAPE OTHER THAN STANDARD PLEASE PROVIDE A DRAWING BELOW:

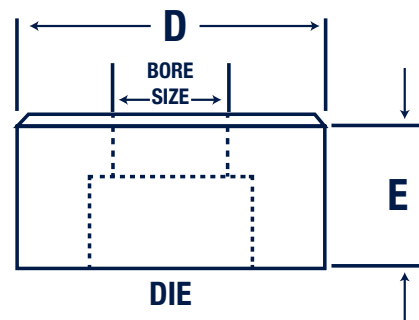
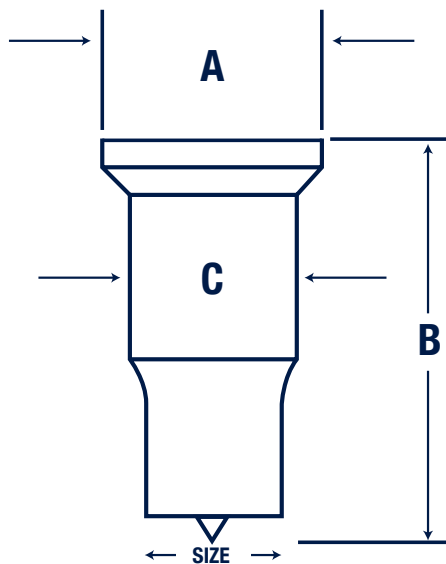

A

D

B

E

C

Fax: 07 3205 5730
Email: sales@punchanddiecentre.com.au

NOTE: ALL PRICES EXCLUDE GST

APPLICATION GUIDELINE

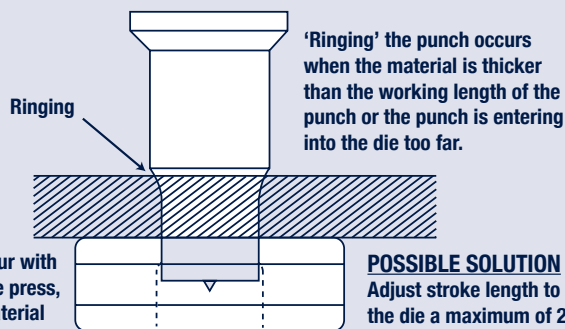

'Ringing' will occur with each stroke of the press, deforming the material

POSSIBLE SOLUTION
Adjust stroke length to enter into the die a maximum of 2mm

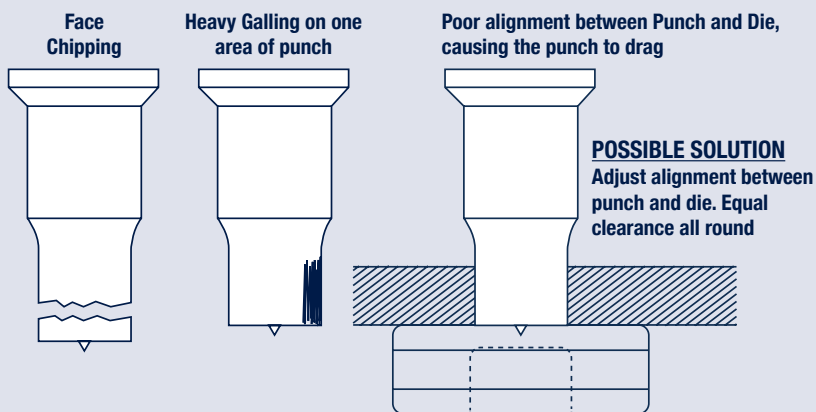

A portion of the punch is broken off in the material

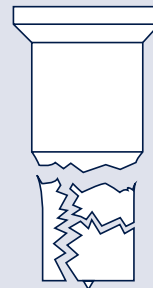
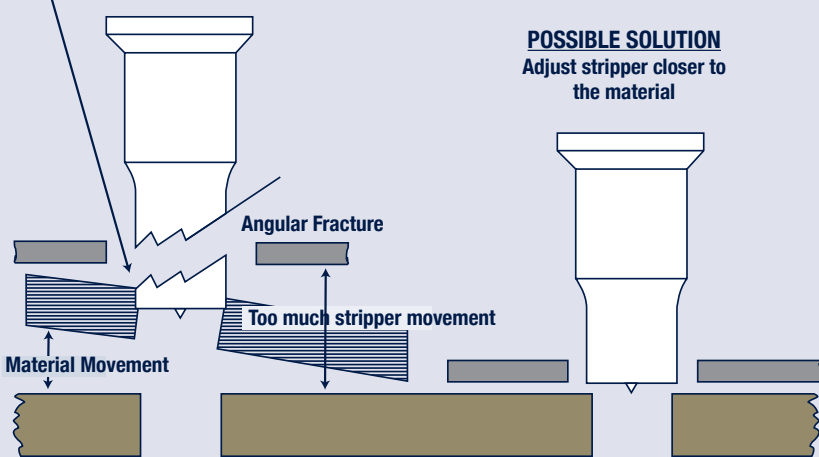

'Compressive Failure' occurs when the compressive strength of the punch has been exceeded and the entire working end shatters. This is caused by attempting to punch extremely hard or thick materials. This could also be caused by complete misalignment of punch and die.

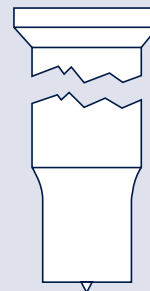

A loose coupling nut, worn punch stem or coupling nut will cause head to fracture

POSSIBLE SOLUTION
Re-tighten coupling nut after the first several hits and periodically throughout the day

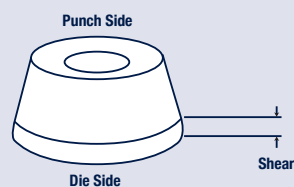

When punching mild steel 3mm or thicker, the side of the slug will be dished. The periphery of the slug will be shiny or sheared, for a distance of 10% to 20% of the material thickness

The punch side will have the center point indentation and a slight burr

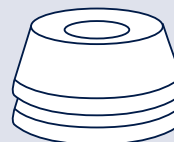

Double shear indicates not enough clearance between punch and die

POSSIBLE SOLUTION
increase die clearance



Heavy burr on the side of material indicates too much clearance between punch and die

POSSIBLE SOLUTION
Decrease die clearance



Uneven burr indicates worn tools or misalignment.

POSSIBLE SOLUTION
Check alignment and condition of die

1. INTRODUCTION

1.1 Application of these Terms and Conditions

The Customer agrees that prior to placing an order with the Supplier, the Customer has read and agreed to the terms and conditions as set out hereunder. For the purposes of this agreement, "Supplier" is QUALITY CUTTING TOOLS PTY LTD A.B.N. 50 089 561 339 and the "Customer" is the applicant named on the account with the Supplier or where no account exists then on the Quote/Work Authorisation provided by the Supplier to the Customer. In this Agreement "Goods" means goods and sharpening services.

2. QUOTE

2.1 Acceptance by the Customer - Where the Supplier has given the Customer a Quote:

- (a) The Supplier need not supply the Customer until the Quote has been accepted by the Customer;
- (b) The Customer shall accept the Quote by instructing (in writing) the Supplier to supply the Goods by signing and returning a true copy of the Quote accompanied by a purchase order number if applicable.
- (c) Acceptance by the Customer of the Quote will constitute acceptance by the Customer of these Terms and conditions.
- (d) Quotes are valid for thirty (30) days only, unless an extension has been authorised by the Supplier.

In acceptance of the Quote, the Customer warrants that it has not relied on any representation by the Supplier and its employees and agents other than as supplied in writing in the Quote.

2.2 Supplier may Revise Quote

The Supplier may amend the Quote after a period of three (3) months from the date of the signed acceptance of the Quote/Work Authorisation to take into account any rise or fall in the cost of performing the Order and the Supplier shall notify the Customer of such amendment as soon as practicable thereafter. Upon the Supplier giving the Customer notification of such amendment the amended quote shall be deemed to be the Quote for the purposes of the Terms and Conditions.

2.3 Variations to Initial Quote

The Customer shall indemnify the Supplier from any additional cost incurred by the Supplier, should the Customer increase the scope of the goods and/or services to be provided by the Supplier.

3. INTELLECTUAL PROPERTY

The Customer warrants, as a fundamental condition of this contract, that all specifications and other unique product information supplied by the Supplier shall be kept confidential in all aspects.

4. INDEMNITY

The Customer shall indemnify the Supplier from all costs incurred when Goods are supplied exclusively to the Customer's specification. These Goods cannot be cancelled.

5. PRICES

Prices set out and referred to in the Reseller's pricelist are recommended prices only and there is no obligation for the Supplier to comply with these recommendations. All prices are subject to alteration without notice.

6. DELIVERY

- 6.1 All deliveries of the Supplier's product will be supplied Freight-On to the Customer.
- 6.2 Delivery of the Goods made to the Customer at the Supplier's address will be on an agreed date and failure by the Customer to uplift completed Goods from the Supplier's address on this agreed date may incur storage charges estimated on a daily basis.
- 6.3 Delivery of Goods to a third party and/or site nominated by the Customer is deemed to be delivery to the Customer for the purpose of this agreement.
- 6.4 The failure of the Supplier to deliver shall not entitle either party to treat this Contract as repudiated. The Supplier shall not be liable for any loss or damage whatsoever due to the failure by the Supplier to deliver the Goods, or any part of them, promptly or at all.
- 6.5 The Customer shall make all arrangements necessary to take delivery of the Goods whenever they are tendered for delivery. Failure to do so may incur additional costs.

7. PAYMENT

7.1 Time for Payment

The Customer must pay QUALITY CUTTING TOOLS PTY LTD the total amount set out in the invoice within 30 days from the date of the invoice.

7.2 Interest

The Supplier may charge interest at 2.5% per calendar month on amounts not paid within the time specified in clause 7.1.

7.3. Damages

The Customer must pay to the Supplier any costs, expenses or losses incurred by the Supplier as a result of the Customer's failure to pay to the Supplier all sums outstanding as owed by the Customer to the Supplier including without limiting the generality of the foregoing any debt collection and legal costs incurred in enforcing payment on a Solicitor and own Customer basis.

7.4 Cancellation

The Customer shall reimburse the Supplier for any costs, expenses or losses incurred by the Supplier should the Customer cancel the accepted Quote/Work Authorisation. The time for payment for such cancellation shall be seven (7) days from the Supplier's invoice.

8. RISK

The risk in the Goods shall pass to the Customer upon delivery and/or installation of the Goods to the Customer or its agent or to a third party nominated by the Customer.

9. RETENTION OF TITLE

9.1 Title

Notwithstanding the delivery of the Goods or their installation, title in any particular Goods shall remain with the Supplier regardless of whether the Goods are on-sold by the Customer until the Customer has paid and discharged any and all monies owing pursuant to any invoice issued by the Supplier for the Goods, including all applicable GST and other taxes, levies and duties.

Any payment made by or on behalf of the Customer which is later avoided by the application of any Statutory Provisions shall be deemed not to discharge the Supplier's title in the Goods nor the Customer's indebtedness to the Supplier and, in such an event, the parties are to be restored to the rights which each respectively would have had if the payment had not been made.

9.2 Bailment

The Customer acknowledges that it is in possession of the Goods solely as Bailee until payment of all invoices for the Goods is made pursuant to clause 6.1 and until that time:

- (a) The Customer is not entitled to sell the Goods but only in the ordinary course of business;
- (b) The Customer must not encumber or otherwise charge the Goods;
- (c) The Customer shall be fully responsible for any loss or damage to the Goods whatsoever and howsoever caused following delivery or installation of the Goods to the Customer.

9.3 Repossession

The Customer hereby irrevocably grants to the Supplier the right, at its sole discretion, to remove or repossess any Goods from the Customer and sell or dispose of them, and the Supplier shall not be liable to the Customer or any person claiming through the Customer and the Supplier shall be entitled to retain the proceeds of any Goods sold and apply same towards the Customer's indebtedness to the Supplier.

If the Customer commits an act of bankruptcy, enters into any form of administration or liquidation, makes any composition or arrangement with its creditors, ceases to carry on business or breaches any fundamental clause of this agreement, then the Supplier may, without prejudice to any other remedies it may have, repossess any Goods delivered to the Customer on any account which has not been paid in accordance with the terms and conditions herein and commence proceedings to recover the balance of any monies owing the Supplier by the Customer.

10. WARRANTY

10.1 The warranty period for the Goods shall be as per the manufacturer's specifications. This is usually six (6) months from the date of purchase unless otherwise stipulated.

10.2 The Supplier will repair or replace any and all material parts found to be defective within the warranty period without charge, provided the Goods have been used in accordance with the manufacturer's and/or Supplier's instructions. No allowance will be made on any Goods for labour, freight or consequential damages, only the cost of the defective Goods.

10.3 Work and/or service carried out on the Goods by anyone other than the Supplier and/or their nominated agents shall make the warranty null and void unless the Customer obtains prior approval from the Supplier before any remedial work is carried out.

10.4 The Supplier reserves the right to make null and void the warranty should the Goods be modified, altered, damaged or put to any undue stress other than in the way the Goods were designed to perform.

10.5 The Customer shall indemnify the Supplier from any warranty connected to the sharpening services provided to the Customer by the Supplier or their agent. The Supplier warrants only that the sharpening service will be performed to manufacturers' specifications.

10.6 In respect of all claims the Supplier shall not be liable to compensate the Customer for any delay in either replacing or repairing the workmanship/Goods or in properly assessing the Customer's claim.

11. DEFECTS

The Customer shall inspect the Goods on delivery and shall within seven (7) days of delivery notify the Supplier of any alleged shortage in quantity, damage or failure to comply with the description. The Customer shall afford the Supplier an opportunity to inspect the Goods within a reasonable time following delivery if the Customer believes the Goods are defective in any way. If the Customer shall fail to comply with these provisions the Goods shall be conclusively presumed to be in accordance with the terms and conditions and free from any damage.

12. RESTOCKING

Subject to prior approval from the Supplier a restocking charge of 15% will be applied on unused Goods sent back for credit or exchange. Freight of unused Goods shall be the Customer's responsibility.

13. LIABILITY

13.1 Non-excludable Rights

The parties acknowledge that, under applicable State and Commonwealth law, certain conditions and warranties may be implied in these Terms and Conditions and there are rights and remedies conferred on the Customer in relation to the provision of the Goods or of services which cannot be excluded, restricted or modified by the Agreement ("Non-excludable Rights").

13.2 Disclaimer of Liability

The Supplier disclaims all conditions and warranties expressed or implied, and all rights and remedies conferred on the Customer, by statute, the common law, equity, trade, custom or usage or otherwise and all those conditions and warranties and all those rights and remedies are excluded other than any Non-excludable Rights. To the extent permitted by law, the liability of the Supplier for a breach of a Non-Excludable Right is limited, at the Supplier's option, to the supplying of the Goods and/or any services again or payment of the cost of having the Goods and/or services supplied again.

13.3 Indirect Losses

Notwithstanding any other provision of these Terms and Conditions, the Supplier is in no circumstances (whatever the cause) liable in contract, tort including without limitation, negligence or breach of statutory duty or otherwise to compensate the Customer for:

- (a) any increased costs or expenses;
- (b) any loss of profit, revenue, business, contracts or anticipated savings;
- (c) any loss or expense resulting from a claim by a third party; or
- (d) any special, indirect or consequential loss or damage of any nature whatsoever caused by the Supplier's failure to complete or delay in completing the Order or to deliver the Goods.

13.4 Force Majeure

The Supplier will have no liability to the Customer in relation to any loss, damage or expense caused by the Supplier's failure to complete the Order or to deliver the Goods as a result of fire, flood, tempest, earthquake, riot, civil disturbance, theft, crime, strike, lockout, breakdown, war, the inability of the Supplier's normal suppliers to supply necessary material or any other matter beyond the Supplier's control.

14. PRIVACY

14.1 The Customer hereby authorises the Supplier to collect, retain, record, use and disclose personal information about the Customer, in accordance with the Privacy Act 1988, to persons and/or legal entities who are a Solicitor or any other professional consultant engaged by the Supplier, a Debt Collector, Credit Reference Organisation and/or any other individual or organisation which maintains credit references and/or default listings.

14.2 The Customer also authorises the Supplier to make enquiries with respect to the Customer's credit worthiness; to exchange information with other Credit Providers in respect to previous defaults of the Customer and to notify other Credit Providers of a default by the Customer.

15. GENERAL MATTERS

15.1 Severability

Any provision in these Terms and Conditions which is invalid or unenforceable in any jurisdiction must be read down for the purposes of that jurisdiction, if possible, so as to be valid and enforceable. If that provision cannot be read down then it is capable of being severed to the extent of the invalidity or unenforceability without affecting the remaining provisions of these Terms and Conditions or affecting the validity or enforceability of that provision in any other jurisdiction.

15.2 Governing Law and Jurisdiction

These Terms and Conditions are governed by the law in force in the State or Territory in which the Supplier's premises are located and the parties submit to the non-exclusive jurisdiction of the courts of that State or Territory and any courts which may hear appeals from those courts in respect of any proceedings in connection with these Terms and Conditions.



Core drills – Hole saws – Step drills –
Conical drills



Solid carbide burs

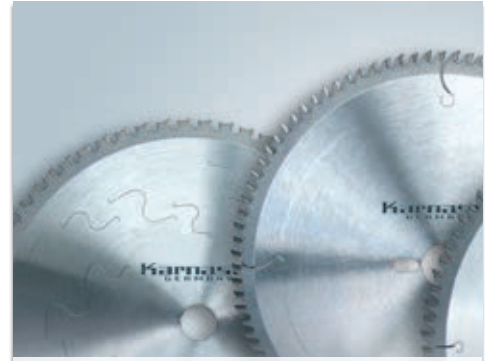

Carbide tipped circular saws



Metal circular saw blades – Segmental saw
blades – Solid carbide saw blades

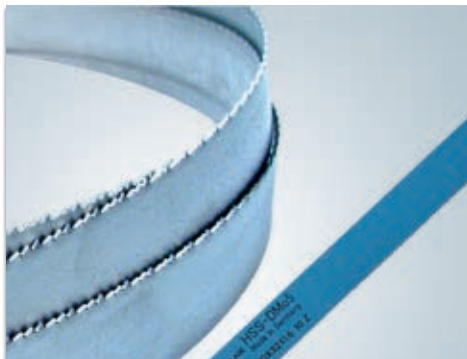

Hacksaws – Handsaws – Bandsaws



End mills/Micro end mills solid carbide –
diamond – PCD – CBN – Cermet – CVD

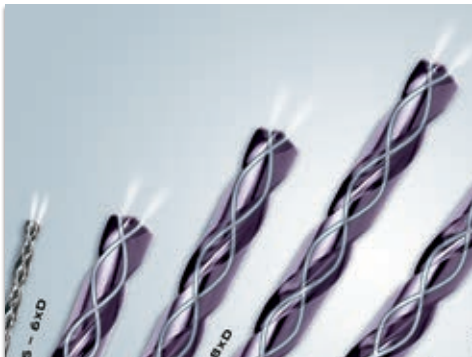

High performance twist drill/Micro twist
drill solid carbide – PKD



Thread mills/Micro thread mills solid carbide



Reamers/Micro reamers solid carbide –
Cermet – PCD



Lubricant and cutting fluids



Tools for aeronautic and space flight
industry – Composites



Magnetic Hole Cutting Machines



PUNCH AND DIE CENTRE

PO Box 488 North Lakes Qld 4509
Unit 13, 8 Oxley Street North Lakes Qld 4509

Ph: 07 3205 2799
Fax: 07 3205 5730

www.punchanddiecentre.com.au

A DIVISION OF:



Karnasch
PROFESSIONAL TOOLS